

**FOR LEASE**  
17,715 sq.ft. divisible

Medical / Professional Office Space  
**DOS LAGOS LAKEFRONT 2**  
Pronio Drive (Parcel 11) - Corona, CA



### **Dos Lagos Lakefront Professional Building**

- Scenic views of Dos Lagos lakes and mountains
- Adjacent to 351,000 sq.ft lifestyle center lakeside restaurants, shops, services, theater & housing in walking distance
- Attractive building in high-quality environment
- Convenient access from Interstate 15
- Abundant 5:1000 parking
- Ideal medical/dental location

Eric Conrad Frickle Commercial Realty | Lic# 00866733 | [broker@ericfrickle.com](mailto:broker@ericfrickle.com) | 951-817-5200

**ERIC  
CONRAD  
FRICKLE**  
COMMERCIAL REALTY

# Dos Lagos Lakefront 2 Conceptual Site Plan

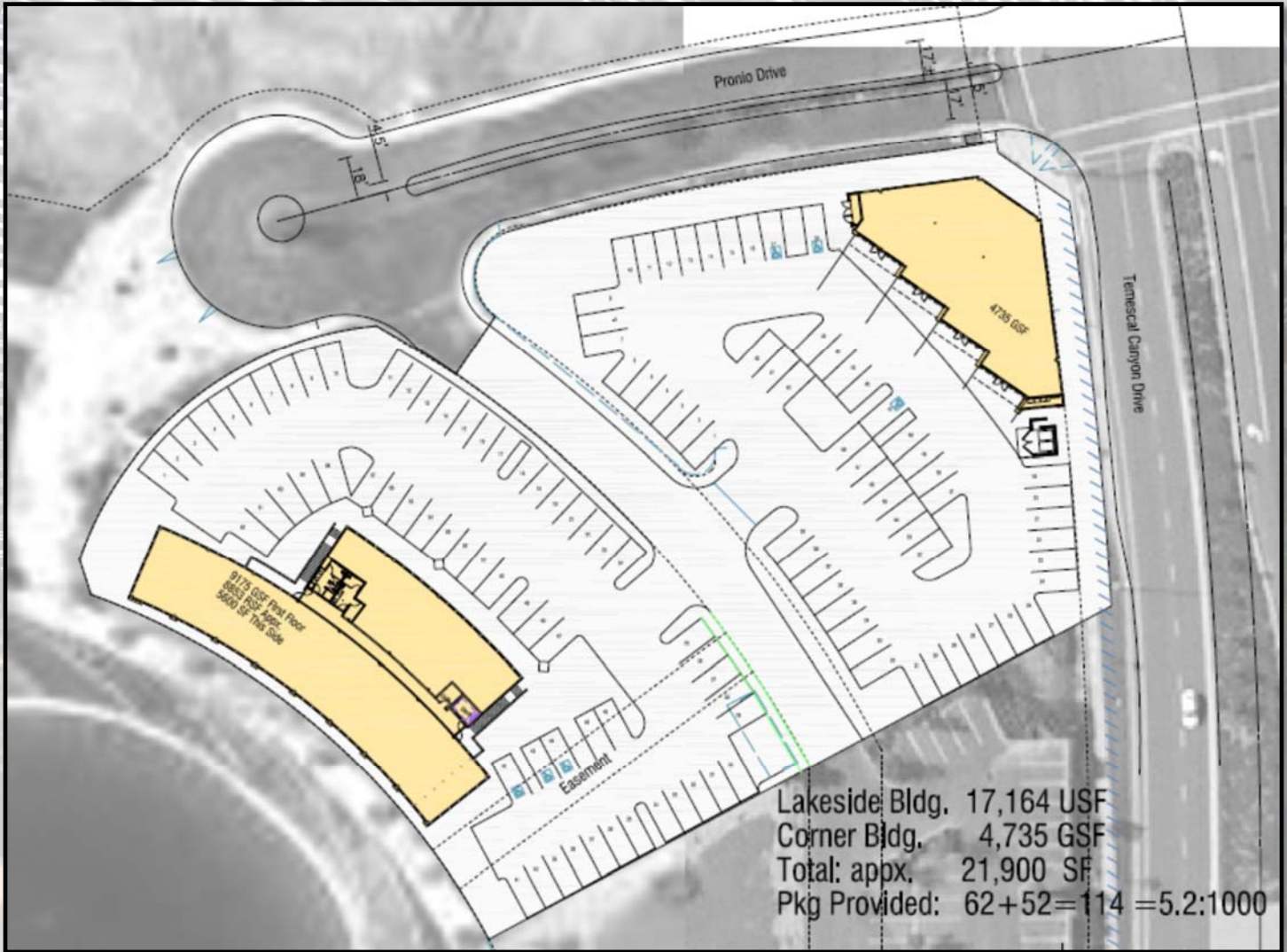

Site plan, floor plan, elevations & specifications are conceptual. Owner reserves right to make changes without notice until such time as a binding lease agreement has been fully executed.

Dos Lagos Lakefront 2  
**Conceptual Floor Plans**

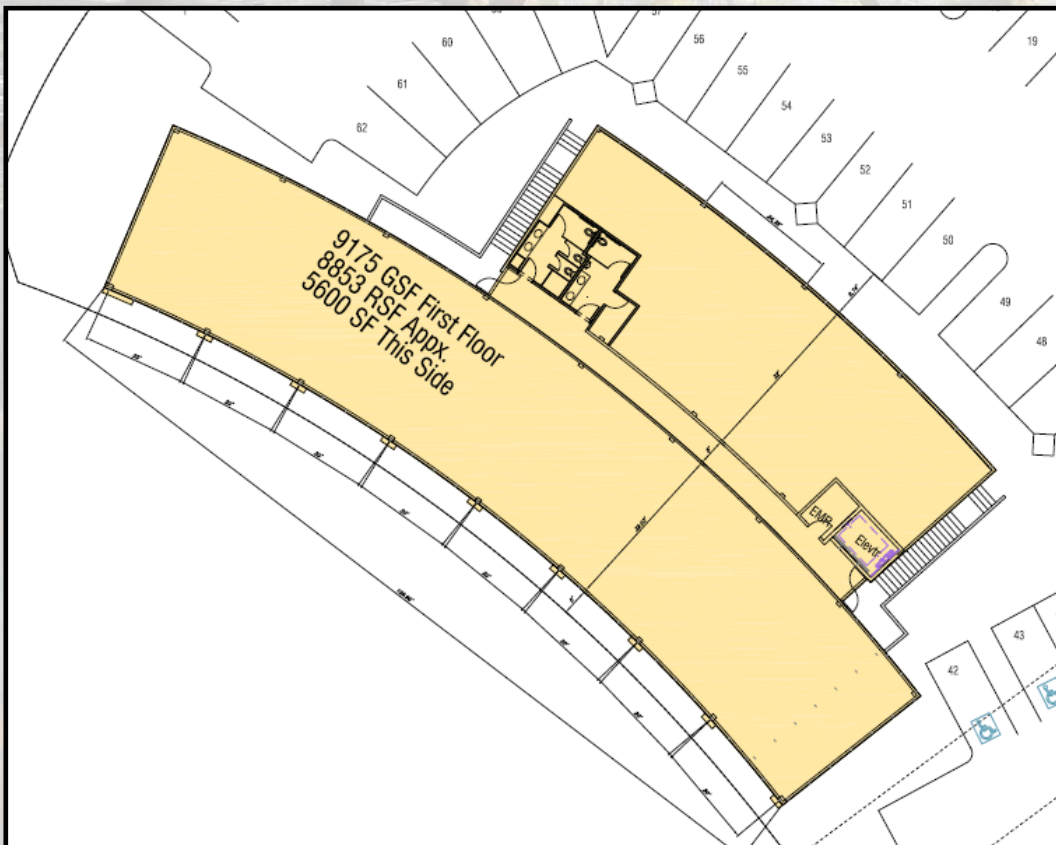
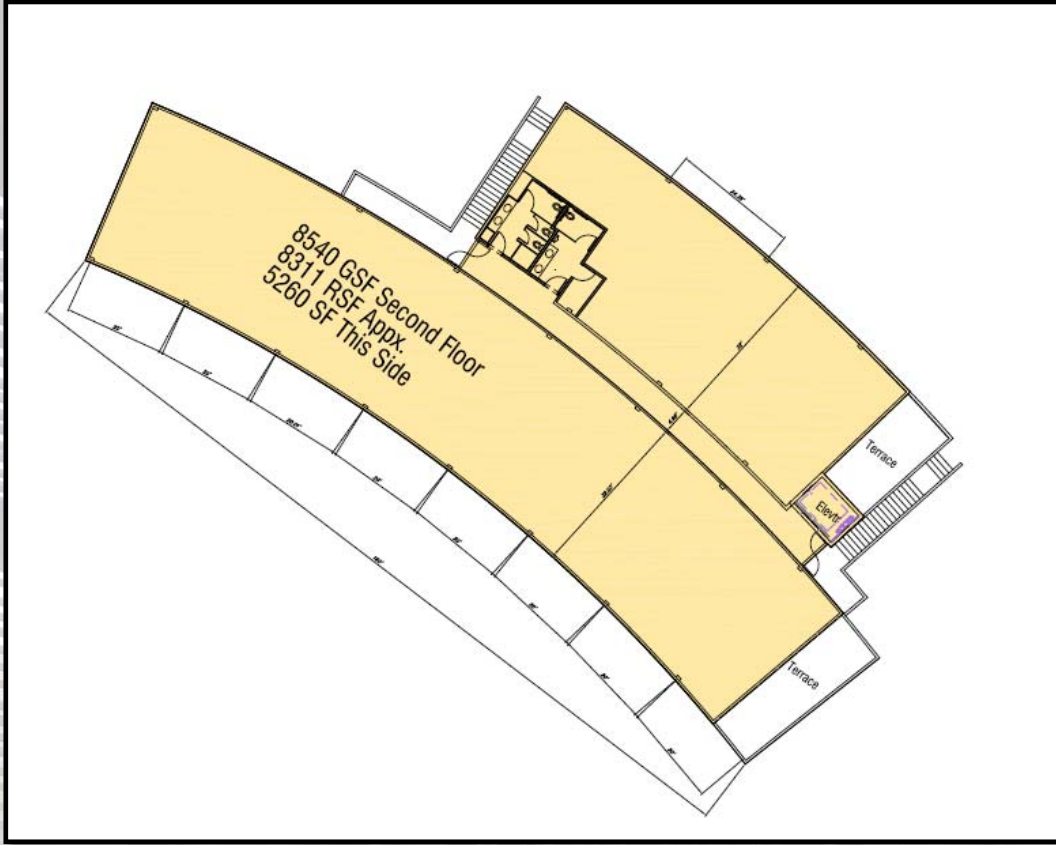

Site plan, floor plan, elevations & specifications are conceptual. Owner reserves right to make changes without notice until such time as a binding lease agreement has been fully executed.

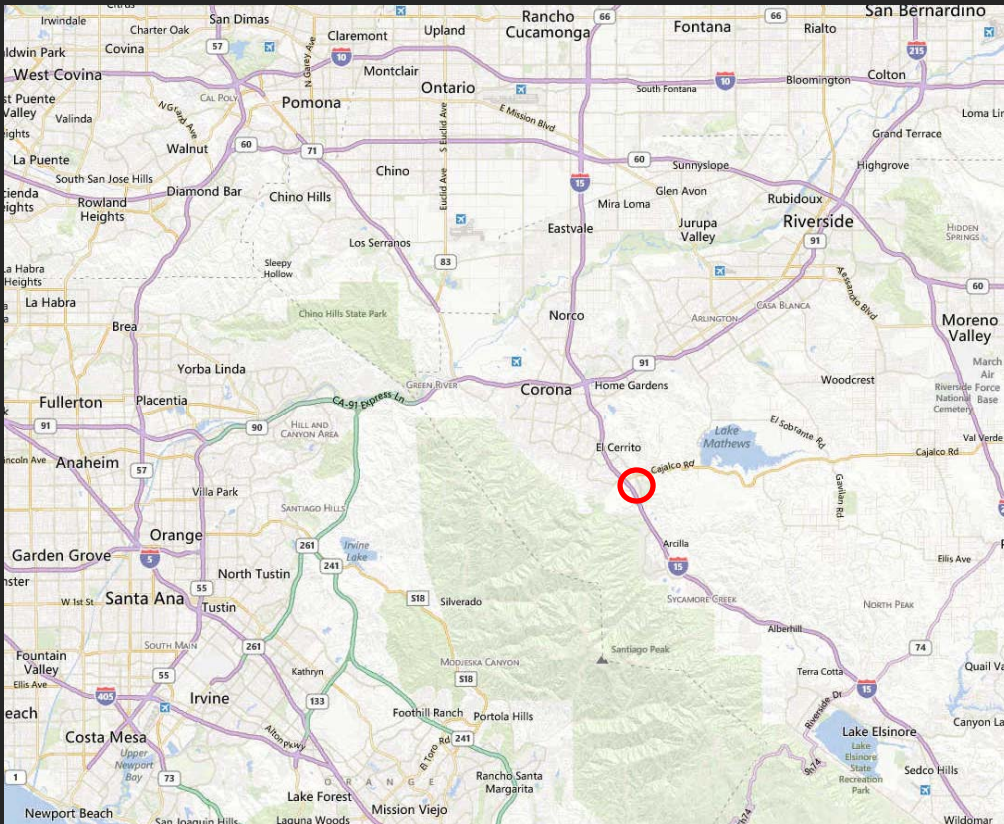

For more information contact:

**Eric Conrad Frickle**  
Commercial Realty  
License #00866733  
ericfrickle.com  
(951) 817-5200

